

AREA PLAN

9 KINGSWAY

Holborn, LONDON, WC2

Basement

Net Internal Area

	OFFICE	351.1 sq m	3779 sq ft
---	--------	------------	------------

TOTAL NIA: **351.1 sq m** **3779 sq ft**

KINGSWAY

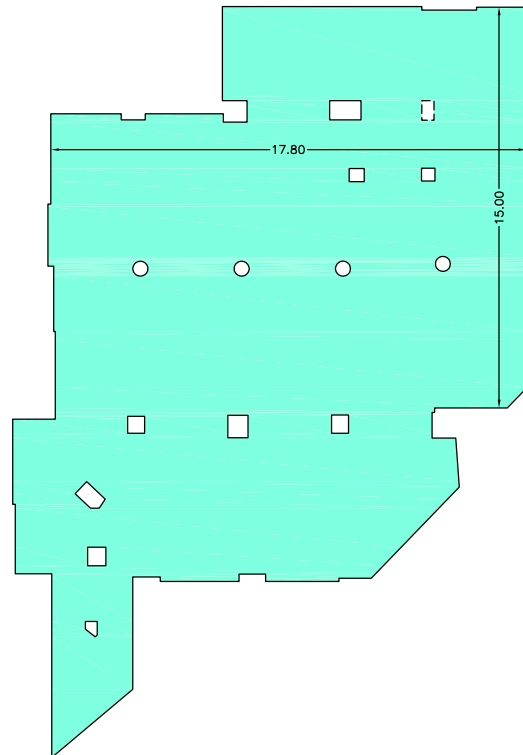

Condition of Site:
Occupied
Vacant
Heavy Fit-Out
Shell & Core
Under Construction
Cat A Fit-Out

Notes:
This drawing complies with the 6th edition of the RICS code and indicates the extent of the areas quoted, produced to an accuracy commensurate with standard presentation scales.
It is held in a scaled digital CAD format.
Dashed line denotes assumed wall line.

Revisions:
A - Original Issue (July 2013)

Dwg No. **29553-AB**

Issue A July 2013

Scaled for presentation purposes

Plowman Craven
Regulated by RICS



 +44(0)1582 765566  www.plowmancraven.co.uk